

DUCTILE IRON PIPE FITTING-TEE

Type: 130

Doc No.: DS-401-130-01-E

1.0 PRODUCT OVERVIEW

Tee, connecting the main pipe, leading to one branch, distributes the flow in the main pipe and the branch pipe.



Dimensions:

3/8"(DN10)-6"(DN150)

Design Standard:

ASME B16.3

Connection Standard:

ANSI/ASME B 1.20.1

Working Pressure:

300PSI

Application:

The malleable iron tee is mainly applied at the medium and low pressure pipeline systems with normal working pressure 300 PSI, and the temperature is -29 °C ~120 °C, such as water supply and drainage, fire protection, HVAC, etc.

Material of Matching Products:

Welded or seamless rolled steel pipe according to ASTM A53-A53M and ASME B36.10.

Surface Treatment:

Sign Off:

Owner: _____ Contractor: _____
Location: _____ Date: _____

Engineer: _____
Approved & Date: _____

- ☐ Black
- ☐ Hot-dip galvanizing
- ☐ Hot-dip galvanizing+ Electroplated zinc
- ☐ Epoxy power painting
- ☐ Electroplated zinc

2.0 APPROVALS

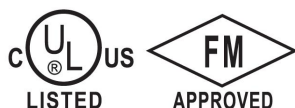

3.0 DIMENSIONS

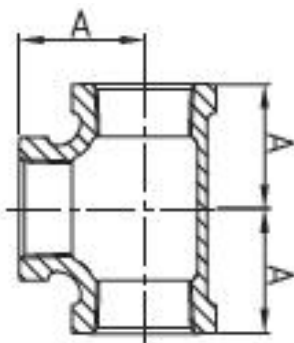

Size	Inch	3/8	1/2	3/4	1	1 1/4	1 1/2
	mm	10	15	20	25	32	40
Dim (mm)	A	24.1	28.5	33.3	38.1	44.5	49.3
Size	Inch	2	2 1/2	3	6		
	mm	50	65	80	150		
Dim (mm)	A	57.2	68.6	78.2	130.3		

4.0 REFERENCE MATERIALS

Approved certification for Ductile Iron Fittings

Sign Off:

Owner: _____ Contractor: _____
Location: _____ Date: _____

Engineer: _____
Approved & Date: _____